

FP30

FIREPLACE
FOR LARGE SPACES

Heat Output Cord Wood
99,000 BTU

38,500 BTU EPA Test Fuel

EFFICIENCY (LHV)	76.8%
EMISSIONS	2.47 GM/HR.
LOG SIZE (MAX)	18-20 INCHES
FIREBOX SIZE	3.0 CU.FT.
GLASS SIZE	246 SQ.IN.
WEIGHT	APPROX. 626 LB.

NEW DESIGN AND CLEARANCES FOR 2015

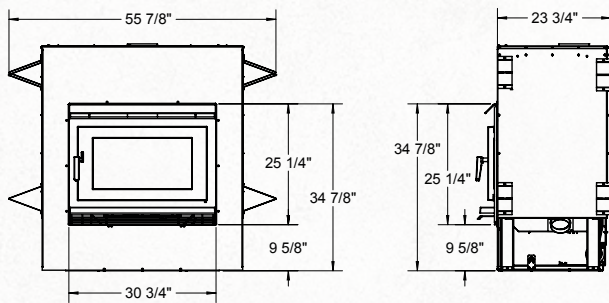

Heat larger spaces with the reduced footprint of a wall-mount fireplace: the FP30 offers the best of traditional wood heat, with a contemporary look and all the Pacific Energy extras. Handcrafted with a floating firebox of heavy gauge steel, a high capacity baffle system, and EBT2 extended heat technology, this full-featured unit is designed for a lifetime of efficient, effective heating. And with clean, uncluttered lines and a huge viewing window (that remains clear with Airwash technology) it meets the highest expectations for form and function.



STANDARD FEATURES

- Reliable, durable non-catalytic technology
- Air wash system for super clean ceramic glass
- Boost air for easy lighting
- Oversize glass viewing window
- Floating firebox for extended stove life
- 304 Stainless Steel Baffle, insulation cover, rails and flame shield
- High-tech multi-port combustion air injection system
- Extended Burn Technology (EBT2)
- Integrated heat exchanger
- North-South loading
- 2x80 cfm temperature actuated blowers
- Single-Lever Air Control
- Cast iron door with ash lip (Contemporary)
- Inside and outside combustion air capable
- Mobile Home Approved
- EPA Certified

PERFORMANCE OPTIONS

- EPA Certified Powered Heat Distribution System
- AIR WASH**
A SYSTEM BY PACIFIC ENERGY
- BAFFLE SYSTEM**
- EBT2 EXTENDED BURN**
TECHNOLOGY
- FLOATING FIREBOX**
- HEAT DISTRIBUTION**
- KNIFE EDGE DOOR**
- SINGLE LEVER**
AIR CONTROL

For reference only. Installations should be based on installation manuals. Specifications subject to change.