

NEO 2.5

INSERT

INSERT

FOR MEDIUM TO LARGE SPACES

Heat Output Cord Wood

85,000 BTU

32,600 BTU EPA Test Fuel

EFFICIENCY (LHV)	80.3%
EFFICIENCY (B415)	74%
EMISSIONS	2.9 GM/HR.
LOG SIZE (MAX)	18 IN.
FIRBOX SIZE	2.5 CU.FT.
GLASS SIZE	166 SQ.IN.
WEIGHT	420 LBS.

Transforms an energy-wasting fireplace into a cost-saving source of heat, without sacrificing the comfort and appeal of the home fire. Accommodating existing masonry fireplaces, the Neo 2.5 insert has Pacific Energy's trusted overbuilt steel construction, including a smooth opening cast iron door, boost air for easy lighting and a one-lever air control for simple operation and maximum burning efficiency. With all the features of the Neo 1.6 in a larger, higher-output format, the Neo 2.5 inserts deliver exceptional performance and durability.

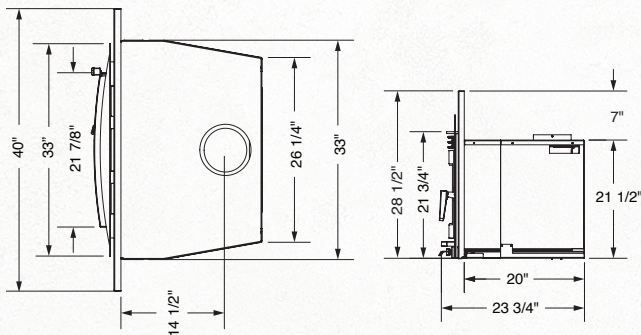

For reference only. Installations should be based on installation manuals. Specifications subject to change.

STANDARD FEATURES

Reliable, durable non-catalytic technology
 Air wash system for super clean ceramic glass
 High-tech multi-port combustion air injection system
 Inside and outside combustion air capable
 Floating firebox for extended stove life
 Rich Metallic Black finish
 304 Stainless Steel Baffle, insulation cover, rails and flame shield
 Extended Burn Technology (EBT2)
 2x80 cfm temperature-actuated variable-speed blower
 Single-Lever Air Control
 Removable Cast-Iron Flue Collar
 East-West loading
 Integrated Heat Exchanger

DESIGN OPTIONS

Contemporary Surround in Metallic Black or Stainless Steel (40" x 28")
 Oversize Surround (48" x 32")



AVAILABLE SURROUNDS

