

TRADITIONAL SERIES
VISTA
INSERT

INSERT
 FOR SMALL TO MEDIUM SPACES

Heat Output Cord Wood

56,000 BTU

26,300 BTU EPA Test Fuel

EFFICIENCY (LHV)	75.5%
EMISSIONS	2.9 GM/HR.
LOG SIZE (RECOMMENDED)	16 IN.
LOG SIZE (MAX)	18 IN.
FIRBOX SIZE	1.4 C.FT.
GLASS SIZE	9103 SQ.IN.
WEIGHT	255 LBS.

For woodstove heating in smaller masonry or factory-built fireplaces, choose the Vista Insert. Designed to deliver efficient combustion and controlled heat, it raises the burn temperature while extending the burn time, providing more heat from less fuel. Like all Pacific Energy inserts it's easy to light, easy to use, and provides a clear view of the flame. With a variable speed fan, clean-glass airwash technology and heavy-gauge overbuilt construction, the Vista will provide many years of comfort and enjoyment.

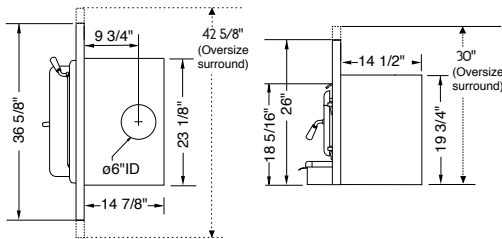

For reference only. Installations should be based on installation manuals. Specifications subject to change.

STANDARD FEATURES

- Reliable, durable non-catalytic technology
- Single-Lever Air Control
- Airwash Technology for clear, clean glass
- Floating firebox for extended stove life
- Plate-steel top
- Steel Baffle and 304 Stainless Steel Insulation cover
- Boost air for easy lighting
- 80 cfm temperature-actuated variable-speed blower
- East-West loading

DESIGN OPTIONS

- Arched door: choice of four finishes
- Embossed Surround, Standard Size (36.5" x 26")
- Embossed Surround, Oversize (42" x 30")
- Flat Surround, Oversize (42" x 30")

